



POINT OF COMMENCEMENT
AT NORTHWEST CORNER OF
US RESERVATION 421

ANACOSTIA FREEWAY
(156' WIDE PUBLIC STREET)

N 81°36'55" E 349.14'

POINT OF
BEGINNING

CHESAPEAKE STREET, S.W.
(90' WIDE PUBLIC STREET)

N 81°36'55" E
378.25

15' BUILDING RESTRICTION LINE

S 5°24'00" E
185.09

S 84°36'00" W
69.03

S 5°24'00" E
201.00

PARCEL 252/90

S 84°36'00" W
21.93

PART OF
US RESERVATION 421

N 00°00'00" W
750.71

FORT GREBLE PLAYGROUND
US RESERVATION 421
261,892 SQ. FT.
6.01221 ACRES

S 00°00'00" W
412.94

PARCEL 252/82

PARCEL 252/83

PARCEL 252/84

PARCEL 252/85

N 90°00'00" W 320.00

ELMIRA STREET, S.W.
(60' WIDE PUBLIC STREET)

AMT LLC
CONSULTING ENGINEERS
10 G STREET, NE, SUITE 430, WASHINGTON, DC, 20002
(202) 289-4545 FAX: (202) 289-5051

DES.	
DRN.	JO
CHK.	DS
FILE:	16-0403.001

EXHIBIT
FORT GREBLE PLAYGROUND
US RESERVATION 421
WASHINGTON, DC

DATE
11/30/17
ZONING COMMISSION
District of Columbia
CASE NO. 17-24
EXHIBIT NO. 5
SHEET
1 OF 2

**Description
Fort Greble Playground
Part of US Reservation 421
November 30, 2017**

Being land know as Fort Greble Playground, as part of U.S. Reservation 421, District of Columbia, as shown on a Transfer of Jurisdiction, per plat thereof December 7, 1972, among the Records of the Office of the Surveyor of the District of Columbia in Recorded Book 158 at Page 140 said land being more particulary described as follow:

Commencing at the northwest corner of US Reservation 421, said point also being the intersection of the east line of Anacostia Freeway, SW (156' wide public street) and the south line of Chesapeake Street, SW (90' wide public street); thence on the south line of said Chesapeake Street, SW **N 81°36'55" E 349.14 feet to the Point of Beginning**; thence continuing on said south line

N 81°36'55" E 378.25 feet; thence departing south said line running in, through and over said US Reservation 421 the following courses and distances.

S 5°24'00" E 185.09 feet; thence

S 84°36'00" E 69.03 feet; thence

S 5°24'00" E 201.00 feet; thence

S 84°36'00" E 21.93 feet; thence

S 00°00'00" E 412.94 feet; thence

N 90°00'00" W 320.00 feet; thence

N 00°00'00" W 750.71 feet to the Point of Beginning.

Containing a recorded area of **6.01221 acres** or **261,892 square feet.**

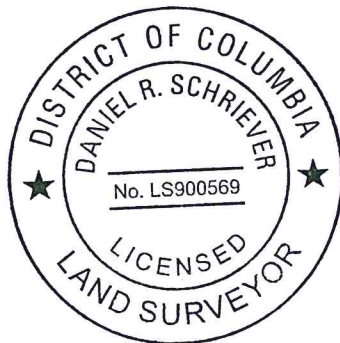

Daniel R. Schriever
License Surveyor
District of Columbia License No. LS 905059
For AMT, LLC